

# CARTIER GEORGE ENESCU

- (M) - 12. Malus niedzwetzkyana h-2,5m,  $\phi$  10cm.
- (C) - 3. Prunus serotata h-2,5m,  $\phi$  10cm.
- (M) - 4, 5, 6, 7, 8, 9 - Malus h-2m,  $\phi$  15cm. (foaletat newst)
- (F) - 10 Jilia tomentosa h-3m,  $\phi$  15cm.
- (M) - 11, 12, 13 - Malus h-3m,  $\phi$  15cm.
- (C) - 14, 15 - Prunus serotata h-3m,  $\phi$  15-20cm
- \* - 16t - 10 buc. Thuja h-2m.
- (F) - 17 Tei-priet.
- (S<sub>1</sub>) - 18 Salcie h-2m,  $\phi$  15cm.
- (S) - 19. Salcòm h-2m,  $\phi$  10cm.
- (M) - 20 Malus h-2m,  $\phi$  15cm
- (C) - 21 - Prunus serotata - h 2,5m  $\phi$  15cm
- (P) - 22 - Prunus persica h-2,5m,  $\phi$  15cm.
- \* - 23, 24 - Chamecyparis h-2m.
- (N) - 25 - Nuc h 4,5m  $\phi$  15cm.



CART. GEORGE ENESCU

SC 1/1000

PARCARI AUTO - 110

str. 23 AUGUST

13-M-11

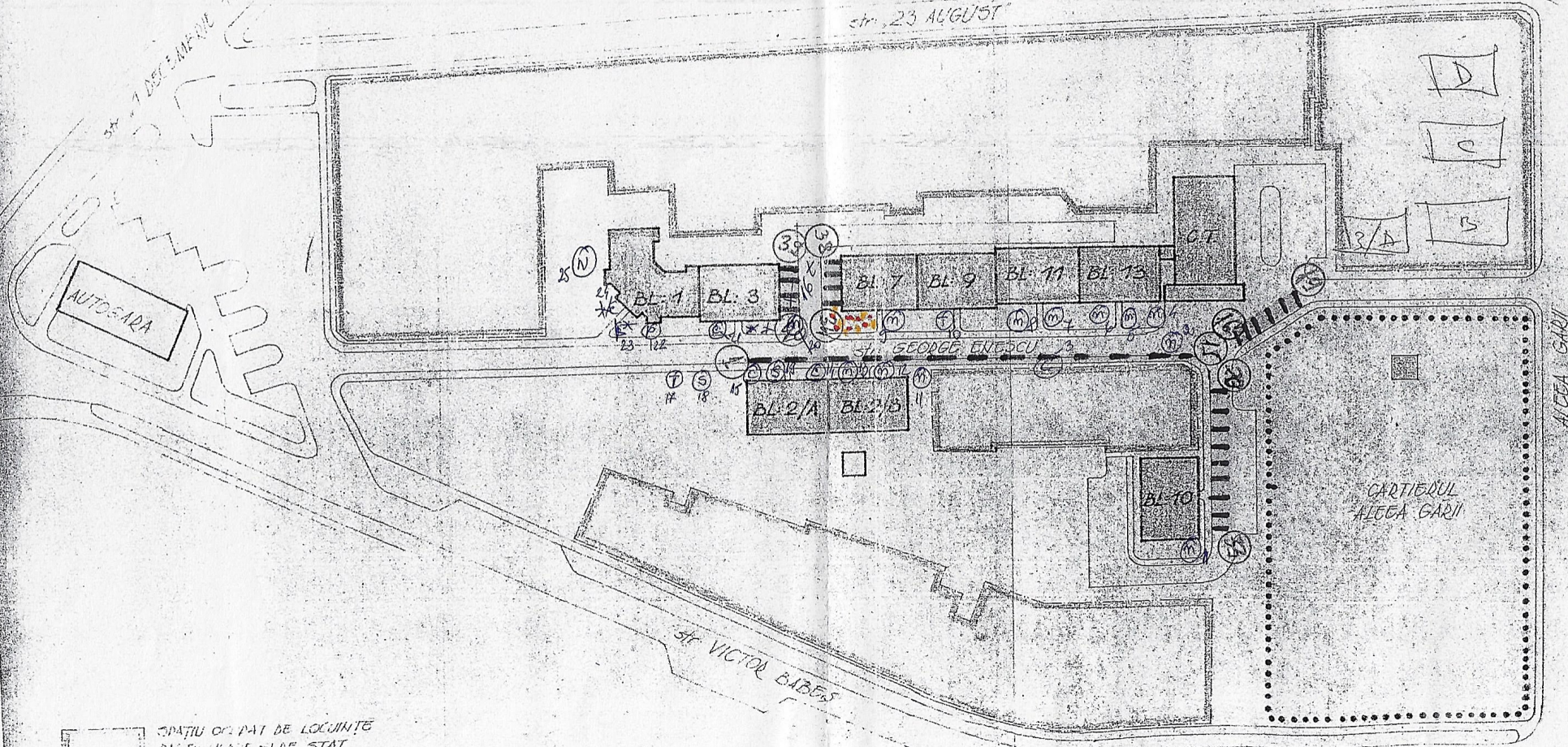

- SPAȚIU OCUPAT DE LOCUINȚE  
PĂRȚICULARE ȘI DE STAT
- ASOCIAȚIA DE LOCATĂRI

ME